

MODEL :		TYPE
PROJECT :		
PREPARED BY :	DATE :	

## SERIES SPECIFICATIONS

WI 2" EMT CONDUIT HANGER



## LINE DRAWING

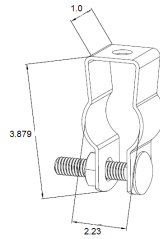

## CONSTRUCTION

Material  
Steel

Plating  
Electro-Plated Zinc

## DIMENSION

Trade Size  
#5B

Emt Size  
2"

Pipe Size  
2"

APPLICATION AND PERFORMANCE SPECIFICATION INFORMATION IS SUBJECT TO CHANGE WITHOUT NOTIFICATION

MODEL :		TYPE
PROJECT :		
PREPARED BY :	DATE :	

ORDERING INFORMATION

Part Number: WI 2-WBA

Package Qty: 20 PCS

IMS Code: 0278-0700

APPLICATION AND PERFORMANCE SPECIFICATION INFORMATION IS SUBJECT TO CHANGE WITHOUT NOTIFICATION