

MODEL :		TYPE
PROJECT :		
PREPARED BY :	DATE :	

SERIES SPECIFICATIONS

WI 3 1/2" EMT CONDUIT HANGER



LINE DRAWING

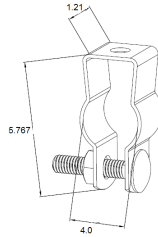

CONSTRUCTION

Material
Steel

Plating
Electro-Plated Zinc

DIMENSION

Trade Size
#8B

Emt Size
NA

Pipe Size
3 1/2"

APPLICATION AND PERFORMANCE SPECIFICATION INFORMATION IS SUBJECT TO CHANGE WITHOUT NOTIFICATION

MODEL :		TYPE
PROJECT :		
PREPARED BY :	DATE :	

ORDERING INFORMATION

Part Number: WI 3 1/2-WBA

Package Qty: 10 PCS

IMS Code: 0278-0703

APPLICATION AND PERFORMANCE SPECIFICATION INFORMATION IS SUBJECT TO CHANGE WITHOUT NOTIFICATION