

MODEL :		TYPE
PROJECT :		
PREPARED BY :	DATE :	

SERIES SPECIFICATIONS

WI 2G 2-3/16: DEEP BOX 3X1/2" H



RoHS
COMPLIANT

LINE DRAWING

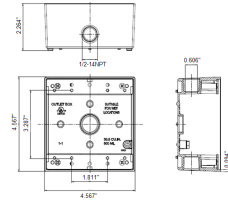

CONSTRUCTION

Material
Die Cast Copper-Free Aluminum

Gang
2

Ground Screw
Included

Finish
Gray

No. of Outlet Holes
3

No. of Closure Plugs
3

DIMENSION

Depth (In.)
2

Height (In.)
4 1/2

Width (In.)
4 9/16

Volume cu. In.
30.5

APPLICATION AND PERFORMANCE SPECIFICATION INFORMATION IS SUBJECT TO CHANGE WITHOUT NOTIFICATION

MODEL :	TYPE
PROJECT :	
PREPARED BY :	DATE :

DIMENSION

Hole Size (In.)
2-Jan

ORDERING INFORMATION

Part Number: WI TGB50/3

Package Qty: 15 PCS

IMS Code: 0278-8437

APPLICATION AND PERFORMANCE SPECIFICATION INFORMATION IS SUBJECT TO CHANGE WITHOUT NOTIFICATION