

CONTRACTOR	
PROJECT	DATE
PREPARED BY	MODEL : WI ELE 90

SERIES SPECIFICATIONS

Centaur's 90 Degree EMT elbow is manufactured from prime EMT conduit in accordance with the latest specifications and standards of ANSI C80.3 (UL797). The interior and exterior surface of elbows are free from defect with a smooth welded seam, and also are thoroughly and evenly coated with zinc using hot dip galvanizing process. Elbows are produced in normal trade sizes from 1/2" to 4" and used to connect the EMT conduit to change the way of the EMT conduit.



LINE DRAWING

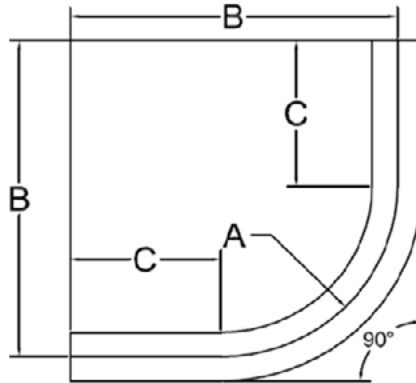

CONSTRUCTION

Material
Steel

Finish
Galvanized

Angle
90°

CERTIFICATIONS/WARRANTY

Listing
UL Listed

Location Rating:
Suitable for damp locations

APPLICATION AND PERFORMANCE SPECIFICATION INFORMATION IS SUBJECT TO CHANGE WITHOUT NOTIFICATION

CONTRACTOR	
PROJECT	DATE
PREPARED BY	MODEL : WI ELE 90

ORDERING INFORMATION

Catalog Number	Trade Size	A IN.	B IN.	C IN.	IMS Code
WI ELE5090	1/2"	4.02	6.87	2.85	0281-2437
WI ELE7590	3/4"	4.49	7.40	2.92	0281-2443
WI ELE10090	1"	5.75	8.74	2.99	0281-2389
WI ELE12590	1 1/4"	7.24	10.56	3.32	0281-2395
WI ELE15090	1 1/2"	8.27	11.91	3.64	0281-2401
WI ELE20090	2"	9.49	13.73	4.24	0281-2407
WI ELE25090	2 1/2"	10.51	15.75	5.24	0281-2413
WI ELE30090	3"	12.99	19.13	6.14	0281-2419
WI ELE35090	3 1/2"	15.00	21.73	6.73	0281-2425
WI ELE40090	4"	15.98	23.10	7.12	0281-2431

APPLICATION AND PERFORMANCE SPECIFICATION INFORMATION IS SUBJECT TO CHANGE WITHOUT NOTIFICATION