

MODEL :		TYPE
PROJECT :		
PREPARED BY :	DATE :	

SERIES SPECIFICATIONS

WI STL COMP CPLG 2-1/2"



LINE DRAWING

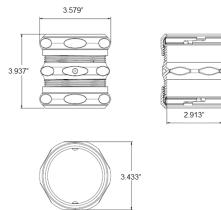

CONSTRUCTION

Material
Steel

Concrete Tight
When Taped

Type
Compression Coupling

Finish
Zinc Electro-Plated

Application
Above 600V

DIMENSION

Length (In.)
3.937

Hexagonal Length (In.)
3.433

Inner Diameter (In.)
2.913

APPLICATION AND PERFORMANCE SPECIFICATION INFORMATION IS SUBJECT TO CHANGE WITHOUT NOTIFICATION

MODEL :		TYPE
PROJECT :		
PREPARED BY :	DATE :	

ORDERING INFORMATION

Part Number: WI MEC-766

Package Qty: 8 PCS

IMS Code: 0285-2892

APPLICATION AND PERFORMANCE SPECIFICATION INFORMATION IS SUBJECT TO CHANGE WITHOUT NOTIFICATION