

MODEL :		TYPE
PROJECT :		
PREPARED BY :	DATE :	

SERIES SPECIFICATIONS

WI STL COMP CPLG 3"



LINE DRAWING

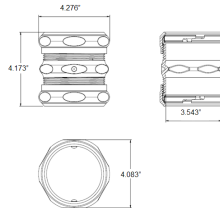

CONSTRUCTION

Material
Steel

Concrete Tight
When Taped

Type
Compression Coupling

Finish
Zinc Electro-Plated

Application
Above 600V

DIMENSION

Length (In.)
4.173

Hexagonal Length (In.)
4.083

Inner Diameter (In.)
3.543

APPLICATION AND PERFORMANCE SPECIFICATION INFORMATION IS SUBJECT TO CHANGE WITHOUT NOTIFICATION

MODEL :		TYPE
PROJECT :		
PREPARED BY :	DATE :	

ORDERING INFORMATION

Part Number: WI MEC-767

Package Qty: 4 PCS

IMS Code: 0285-2895

APPLICATION AND PERFORMANCE SPECIFICATION INFORMATION IS SUBJECT TO CHANGE WITHOUT NOTIFICATION