

MODEL :		TYPE
PROJECT :		
PREPARED BY :	DATE :	

SERIES SPECIFICATIONS

WI STL SET SCREW CPLG 2-1/2"



LINE DRAWING

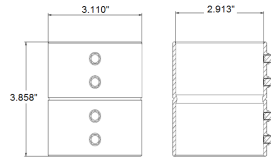

CONSTRUCTION

Material
Steel

Type
Coupling

Finish
Zinc Electro-Plated

Application
Above 600V

DIMENSION

Trade Size
2 1/2

Length (In.)
4.272

Diameter (In.)
2.921

Hexagonal Length (In.)
-

Dimple Diameter (In.)
2.807

APPLICATION AND PERFORMANCE SPECIFICATION INFORMATION IS SUBJECT TO CHANGE WITHOUT NOTIFICATION

MODEL :		TYPE
PROJECT :		
PREPARED BY :	DATE :	

DIMENSION (Cont.)

Screw Size
1/4-28 UNF x 0.41FHCP or 1/4-20 UNC x
0.41FHCP

ORDERING INFORMATION

Part Number: WI MES-766

Package Qty: 8 PCS

IMS Code: 0285-3042

APPLICATION AND PERFORMANCE SPECIFICATION INFORMATION IS SUBJECT TO CHANGE WITHOUT NOTIFICATION