

CONTRACTOR	
PROJECT	DATE
PREPARED BY	MODEL : WITC100

SERIES SPECIFICATIONS

1 gang weatherproof toggle switch cover for use whenever weatherproof protection is required for an "on-off" type switch.



LINE DRAWING

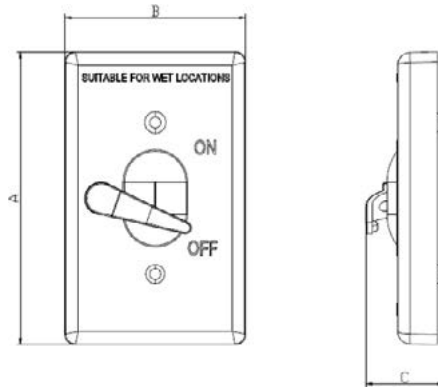

CONSTRUCTION

Body Material
Aluminum

Gang
Single Gang

Screw Size
6-32UNC x 1in.

DIMENSIONS

A (+/- 0.02)
4.587

B (+/- 0.02)
2.835

C (+/- 0.04)
1.220

APPLICATION AND PERFORMANCE SPECIFICATION INFORMATION IS SUBJECT TO CHANGE WITHOUT NOTIFICATION

CONTRACTOR	
PROJECT	DATE
PREPARED BY	MODEL : WITC100

CERTIFICATIONS/WARRANTY

Listing
UL Listed

Location Rating:
Suitable for Wet locations

ORDERING INFORMATION

Catalog Number	Color	IMS Code
WITC100	Gray	0291-5157
WITC100BZ	Bronze	0291-5163
WITC100W	White	0291-5160

APPLICATION AND PERFORMANCE SPECIFICATION INFORMATION IS SUBJECT TO CHANGE WITHOUT NOTIFICATION