

MODEL :		TYPE
PROJECT :		
PREPARED BY :	DATE :	

## SERIES SPECIFICATIONS

4" Type LB Access Fitting



## LINE DRAWING

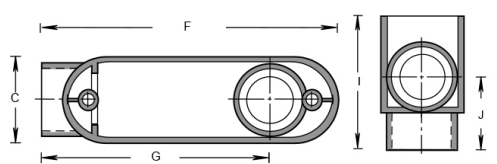

## CONSTRUCTION

Housing Material  
PVC

Size  
4"

Color  
Gray

Fitting  
Slip

Type  
LB

## DIMENSIONS

C (In.)  
5.54

F (In.)  
16

I (In.)  
7.5

G  
11.465

J  
4.525

APPLICATION AND PERFORMANCE SPECIFICATION INFORMATION IS SUBJECT TO CHANGE WITHOUT NOTIFICATION

MODEL :		TYPE
PROJECT :		
PREPARED BY :	DATE :	

## DIMENSIONS (Cont.)

Fill Volume (cu.in) 339	Fill Volume (cu.cm) 5553	l (In.) 7.5
Maximum Wire Fill N/A	UL 514 investigation for the conductor with no investigation	Maximum wire fill marked on body #350
Distance between hubs 9.5"	7.94"	

## ORDERING INFORMATION

Part Number: LB4

Case Dimensions (in.): 23" x 12.9" x 13.8"

Case Quantity: 4 PCS

Case Weight (lbs.): 19.5

Cubic Ft.: 2.36

APPLICATION AND PERFORMANCE SPECIFICATION INFORMATION IS SUBJECT TO CHANGE WITHOUT NOTIFICATION



**CENTAUR**  
ELECTRICAL INSTALLATION

635 NW ENTERPRISE DR. PORT ST. LUCIE, FL 34986 | 772.344.9436 | WWW.CENTAURINSTALLATION.COM