

MODEL :		TYPE
PROJECT :		
PREPARED BY :	DATE :	

## SERIES SPECIFICATIONS

3/4" Type LL Access Fitting



## LINE DRAWING

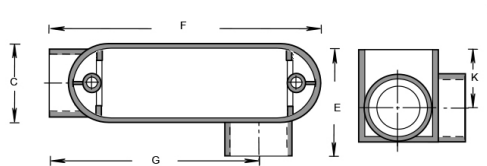

## CONSTRUCTION

Housing Material  
PVC

Size  
3/4"

Color  
Gray

Fitting  
Slip

Type  
LL

## DIMENSIONS

C (In.)  
1.5

F (In.)  
4.97

E (In.)  
2.204

G (In.)  
3.98

K (In.)  
0.92

APPLICATION AND PERFORMANCE SPECIFICATION INFORMATION IS SUBJECT TO CHANGE WITHOUT NOTIFICATION

MODEL :		TYPE
PROJECT :		
PREPARED BY :	DATE :	

## DIMENSIONS (Cont.)

Fill Volume (cu.in)  
7.6

Fill Volume (cu.cm)  
124.6

Maximum wire fill marked on  
body  
N/A

Maximum Wire Fill  
Max wire fill #6 AWG conductors or  
smaller

UL 514 investigation for the  
conductor with no investiga-  
tion  
N/A

Distance between hubs  
N/A

## ORDERING INFORMATION

Part Number: LL07

Case Dimensions (in.): 12" x 8" x 6.5"

Case Quantity: 20 PCS

Case Weight (lbs.): 6

Cubic Ft.: 0.36

APPLICATION AND PERFORMANCE SPECIFICATION INFORMATION IS SUBJECT TO CHANGE WITHOUT NOTIFICATION



635 NW ENTERPRISE DR. PORT ST. LUCIE, FL 34986 | 772.344.9436 | WWW.CENTAURINSTALLATION.COM