

MODEL :		TYPE
PROJECT :		
PREPARED BY :	DATE :	

SERIES SPECIFICATIONS

ALUM C CONDULET 1 1/2"W/COVER & GSKT



LINE DRAWING

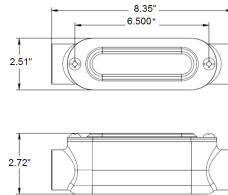

CONSTRUCTION

Material
Die Cast Copper-Free Aluminum

Finish
Powder Coat

Gasket
Neoprene

Type
C

DIMENSION

Trade Size
1 1/2

Depth
2 1/2

Length
8 3/8

Width
2 1/2

APPLICATION AND PERFORMANCE SPECIFICATION INFORMATION IS SUBJECT TO CHANGE WITHOUT NOTIFICATION

MODEL :		TYPE
PROJECT :		
PREPARED BY :	DATE :	

DIMENSION

Cover Length
7 5/16

Conduit Opening
2 3/16

ORDERING INFORMATION

Part Number: WI C150

Package Qty: 2 PCS

IMS Code: 0256-4220

APPLICATION AND PERFORMANCE SPECIFICATION INFORMATION IS SUBJECT TO CHANGE WITHOUT NOTIFICATION