

MODEL :		TYPE
PROJECT :		
PREPARED BY :	DATE :	

SERIES SPECIFICATIONS

ALUM LR CONDULET 2: W/COVER & GSKT



LINE DRAWING

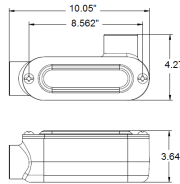

CONSTRUCTION

Material
Die Cast Copper-Free Aluminum

Finish
Powder Coat

Gasket
Neoprene

Type
LR

DIMENSION

Trade Size
2

Depth
4 9/32

Length
10 1/16

Width
3 3/16

APPLICATION AND PERFORMANCE SPECIFICATION INFORMATION IS SUBJECT TO CHANGE WITHOUT NOTIFICATION

MODEL :		TYPE
PROJECT :		
PREPARED BY :	DATE :	

DIMENSION

Cover Length
9 1/2

Conduit Opening
3 3/8

ORDERING INFORMATION

Part Number: WI LR200

Package Qty: 1 PCS

IMS Code: 0256-4229

APPLICATION AND PERFORMANCE SPECIFICATION INFORMATION IS SUBJECT TO CHANGE WITHOUT NOTIFICATION