

MODEL :		TYPE
PROJECT :		
PREPARED BY :	DATE :	

**SERIES SPECIFICATIONS**

WI 3" EMT CONDUIT HANGER



**LINE DRAWING**

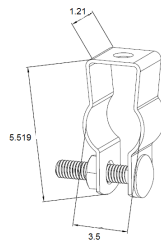

**CONSTRUCTION**

Material  
Steel

Plating  
Electro-Plated Zinc

**DIMENSION**

Trade Size  
#7B

Emt Size  
3"

Pipe Size  
3"

APPLICATION AND PERFORMANCE SPECIFICATION INFORMATION IS SUBJECT TO CHANGE WITHOUT NOTIFICATION

MODEL :		TYPE
PROJECT :		
PREPARED BY :	DATE :	

ORDERING INFORMATION

Part Number: WI 3-WBA

Package Qty: 10 PCS

IMS Code: 0278-0706

APPLICATION AND PERFORMANCE SPECIFICATION INFORMATION IS SUBJECT TO CHANGE WITHOUT NOTIFICATION