

MODEL :		TYPE
PROJECT :		
PREPARED BY :	DATE :	

SERIES SPECIFICATIONS

WI TGB SERIES

2 GANG WEATHERPROOF BOX 2-3/16" DEEP 5 X 1"
HOLE- GRAY



LINE DRAWING

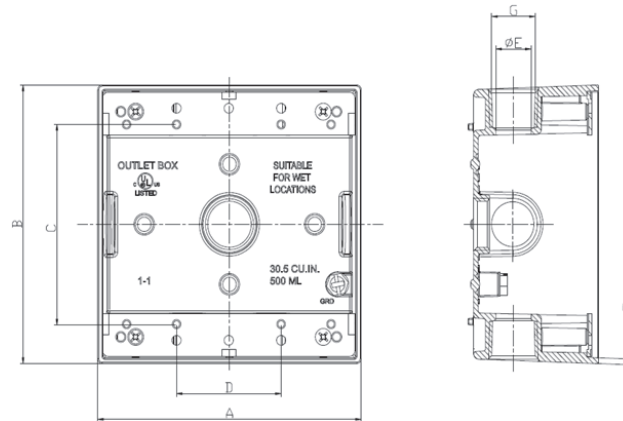

CONSTRUCTION

Material
Aluminum

Gang
2

Ground Screw
Included

Finish
Gray

No. of Outlet Holes
5

Screw Size
6-32UNC X 0.37in or 10-24UNC X 0.24in

DIMENSION

A (In.)
4.567

A (mm)
116.0018

B (In.)
4.567

B (mm)
116.0018

APPLICATION AND PERFORMANCE SPECIFICATION INFORMATION IS SUBJECT TO CHANGE WITHOUT NOTIFICATION

MODEL :		TYPE
PROJECT :		
PREPARED BY :	DATE :	

DIMENSION (CONT.)

C (In.)	C (mm)
3.287	83.4898
D (In.)	D (mm)
1.811	45.9994
E (In.)	E (mm)
1.024	26.0096
F (In.)	F (mm)
0.094	2.3876
NPT Gauge	Volume (Cu. In.)
1-11.5NPT	30.5 CU. IN.

LISTINGS/RATINGS

Listings
UL Listed

Location Ratings
Suitable for Wet Locations

ORDERING INFORMATION

Part Number: WITGB100/5X

IMS Code: 0278-8434

Master Carton Qty: 15 PCS

Pallet Qty: 1215 PCS

Master Carton Dimensions : 14x4.8x11.4 In.

Pallet Dimensions : 44.09x44.09x39.37 In.

APPLICATION AND PERFORMANCE SPECIFICATION INFORMATION IS SUBJECT TO CHANGE WITHOUT NOTIFICATION