

MODEL :		TYPE
PROJECT :		
PREPARED BY :	DATE :	

SERIES SPECIFICATIONS

WI 90D RIGID CONDUIT ELBOW 1-1/4"



LINE DRAWING

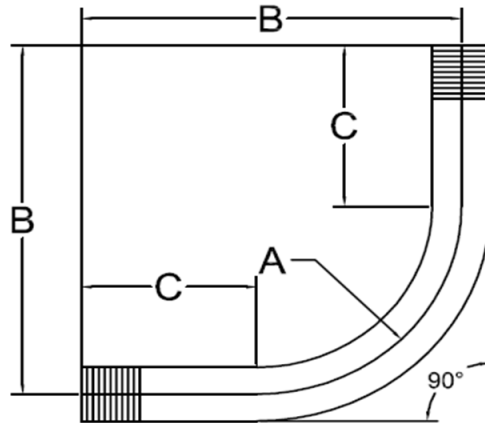

CONSTRUCTION

Material
Steel

Angle
90

Finish
Galvanized

DIMENSION

Pipe Wall Thickness (mm)
3.5

Min UL Radius A (mm)
184.15

Offset B (mm)
260

Straight Length C (mm)
68.26

Flex/Rigid Size
1-1/4"

APPLICATION AND PERFORMANCE SPECIFICATION INFORMATION IS SUBJECT TO CHANGE WITHOUT NOTIFICATION

MODEL :		TYPE
PROJECT :		
PREPARED BY :	DATE :	

ORDERING INFORMATION

Part Number: WI ELR12590

IMS Code: 0281-2335

APPLICATION AND PERFORMANCE SPECIFICATION INFORMATION IS SUBJECT TO CHANGE WITHOUT NOTIFICATION