

MODEL :		TYPE
PROJECT :		
PREPARED BY :	DATE :	

SERIES SPECIFICATIONS

WI 90D RIGID CONDUIT ELBOW 1-1/2"



LINE DRAWING

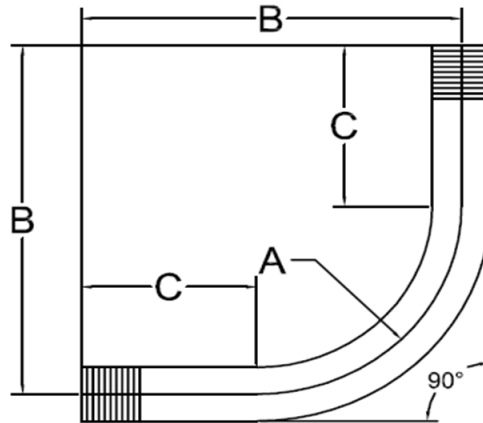

CONSTRUCTION

Material
Steel

Angle
90

Finish
Galvanized

DIMENSION

Pipe Wall Thickness (mm)
3.5

Min UL Radius A (mm)
209.55

Offset B (mm)
310

Straight Length C (mm)
82.55

Flex/Rigid Size
1-1/2"

APPLICATION AND PERFORMANCE SPECIFICATION INFORMATION IS SUBJECT TO CHANGE WITHOUT NOTIFICATION

MODEL :		TYPE
PROJECT :		
PREPARED BY :	DATE :	

ORDERING INFORMATION

Part Number: WI ELR15090

IMS Code: 0281-2341

APPLICATION AND PERFORMANCE SPECIFICATION INFORMATION IS SUBJECT TO CHANGE WITHOUT NOTIFICATION