

MODEL :		TYPE
PROJECT :		
PREPARED BY :	DATE :	

## SERIES SPECIFICATIONS

WI 90D RIGID CONDUIT ELBOW 2-1/2"



## LINE DRAWING

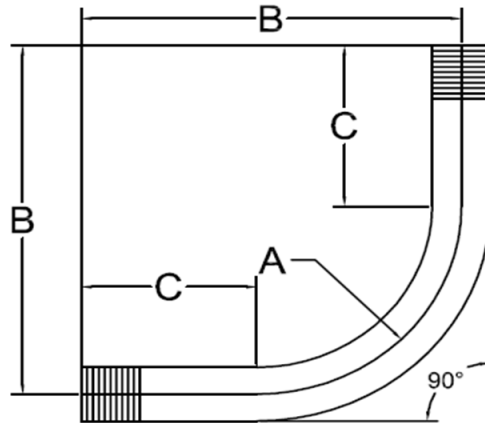

## CONSTRUCTION

Material  
Steel

Angle  
90

Finish  
Galvanized

## DIMENSION

Pipe Wall Thickness (mm)  
4.5

Min UL Radius A (mm)  
266.7

Offset B (mm)  
420

Straight Length C (mm)  
133.35

Flex/Rigid Size  
2-1/2"

APPLICATION AND PERFORMANCE SPECIFICATION INFORMATION IS SUBJECT TO CHANGE WITHOUT NOTIFICATION

MODEL :		TYPE
PROJECT :		
PREPARED BY :	DATE :	

ORDERING INFORMATION

Part Number: WI ELR25090

IMS Code: 0281-2353

APPLICATION AND PERFORMANCE SPECIFICATION INFORMATION IS SUBJECT TO CHANGE WITHOUT NOTIFICATION