

MODEL :		TYPE
PROJECT :		
PREPARED BY :	DATE :	

SERIES SPECIFICATIONS

WI 90D RIGID CONDUIT ELBOW 3/4"



LINE DRAWING

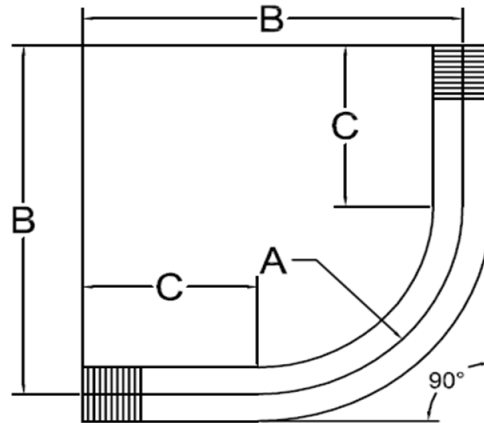

CONSTRUCTION

Material
Steel

Angle
90

Finish
Galvanized

DIMENSION

Pipe Wall Thickness (mm)
2.75

Min UL Radius A (mm)
114.3

Offset B (mm)
180

Straight Length C (mm)
50.8

Flex/Rigid Size
3/4"

APPLICATION AND PERFORMANCE SPECIFICATION INFORMATION IS SUBJECT TO CHANGE WITHOUT NOTIFICATION

MODEL :		TYPE
PROJECT :		
PREPARED BY :	DATE :	

ORDERING INFORMATION

Part Number: WI ELR7590

IMS Code: 0281-2383

APPLICATION AND PERFORMANCE SPECIFICATION INFORMATION IS SUBJECT TO CHANGE WITHOUT NOTIFICATION