

MODEL :		TYPE
PROJECT :		
PREPARED BY :	DATE :	

SERIES SPECIFICATIONS

4" PANCAKE BOX, 1/2" DEEP, WITH NM CLAMP



LINE DRAWING

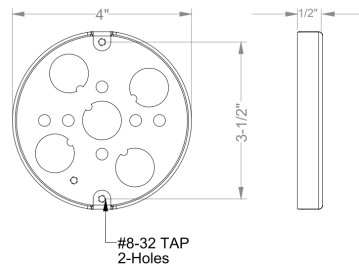

CONSTRUCTION

Material
16 Ga Sheet Steel

Clamp Type
Accommodates #14-2
Non-Metallic Sheathed Ca-
bles with ground

DIMENSIONS

Depth (In.)
1/2

Diameter (In.)
4

Knockouts
(3) - 1/2", (4) - Circ.Pryouts

Cover Screw
8-32

Cover Screw Spacing
3 1/2

Cubic In.
5.8

APPLICATION AND PERFORMANCE SPECIFICATION INFORMATION IS SUBJECT TO CHANGE WITHOUT NOTIFICATION

MODEL :	TYPE
PROJECT :	
PREPARED BY :	DATE :

ORDERING INFORMATION

Part Number: CM-4PB-NM

Case Weight (lbs.): 17.5

Case Quantity: 50 PCS

APPLICATION AND PERFORMANCE SPECIFICATION INFORMATION IS SUBJECT TO CHANGE WITHOUT NOTIFICATION