

CONTRACTOR	
PROJECT	DATE
PREPARED BY	MODEL : CM-4SDB-MKO-MS

SERIES SPECIFICATIONS

Centaur's 4" Square (4S) Deep Boxes are used to install lighting fixtures, switches, and receptacles in ceilings and walls. They are constructed from 16 gauge galvanized steel. These 2-1/8" deep, welded boxes include metal clad cable clamps for ease of installation. CM-4SDB-MKO-MS includes a self gripping metal stud bracket with box support clip. Engages on either side of metal stud. All Centaur steel boxes are UL listed and acceptable for use in 2-hour fire rated walls.



LINE DRAWING

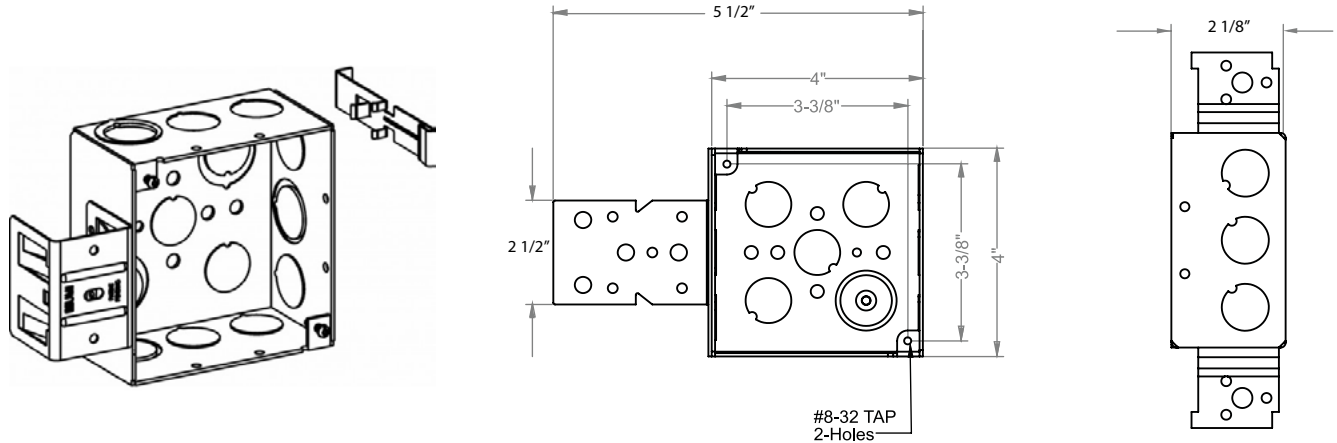

CONSTRUCTION

Material
Galvanized Steel

Make
Welded

Color
Galvanized

Material Thickness
16 Ga.

Knockout Sides
(6) 1/2", (3) MKO

Knockout Bottom
(3) 1/2", (2) MKO

Bracket Type
MS, Self-Gripping+Box support clip

Width
4"

Height
4"

Depth
2 1/8"

Volume
30.3 Cu. In.

Bracket Details
(L: 2-1/2", W: 1-3/8") Offset
(Flush) Self-Gripping Metal Stud Bracket with Box Support Clip.

Includes
WB Bracket uses positioning spurs for mounting box on side of stud

APPLICATION AND PERFORMANCE SPECIFICATION INFORMATION IS SUBJECT TO CHANGE WITHOUT NOTIFICATION

CONTRACTOR	
PROJECT	DATE
PREPARED BY	MODEL : CM-4SDB-MKO-MS

CERTIFICATIONS

Listing
UL Listed

Fire Rating
Acceptable for use in 2-hour fire rated walls.

ORDERING INFORMATION

Part Number: CM-4SDB-MKO-MS

Case Dimensions (in.): ???

Case Quantity: 24 PCS

Item Weight (lbs.): ???

Case Weight (lbs.): 22.5

UPC BARCODES

	GTIN-12	GTIN-14	IMS Code
CM-4SDB-MKO-MS	190010381135	00190010381135	0262-7898



0262789801127906



1 90010 38113 5

APPLICATION AND PERFORMANCE SPECIFICATION INFORMATION IS SUBJECT TO CHANGE WITHOUT NOTIFICATION