

CONTRACTOR	
PROJECT	DATE
PREPARED BY	MODEL : CM-GDB-1

SERIES SPECIFICATIONS

Centaur's 3-1/2" Deep Gangable Switch Boxes are used in the installation of switches. Models include a pre-assembled 10-32 ground screw and a solid #12AWG 7" Pigtail for ground applications. They are constructed from 16 gauge galvanized steel. All Centaur steel boxes are UL listed and acceptable for use in 2-hour fire rated walls. Includes removable side cover for multigang applications and pre-assembled 7" solid cu. #12AWG pigtail and 10-32 ground screw.



LINE DRAWING

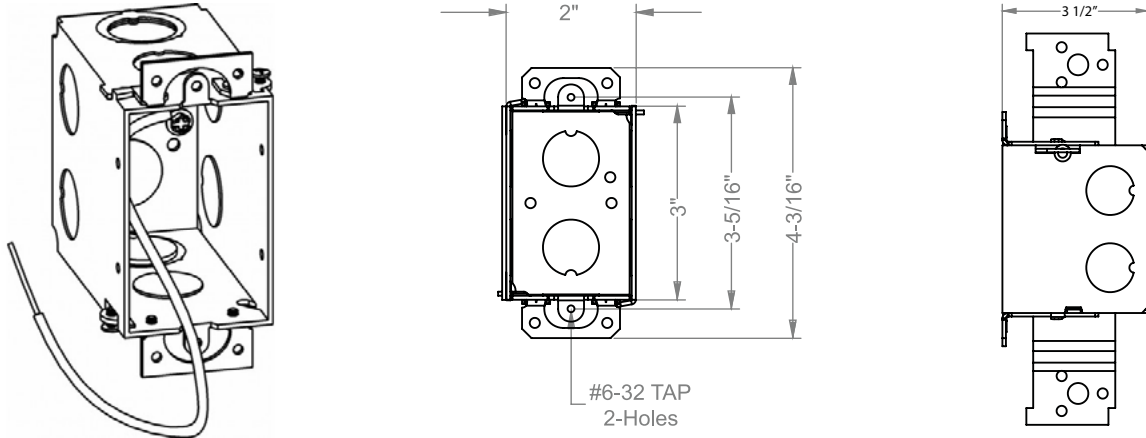

CONSTRUCTION

Material
Galvanized Steel

Make
Welded

Color
Galvanized

Material Thickness
16 Ga.

Width
2"

Height
3"

Depth
3 1/2"

Volume
18 Cu. In.

No. of Gangs
1, Gangable

Knockout Details
MKO: Moon (1/2" and 3/4" KO)

Knockout Sides
(4) 1/2"

Knockout Bottom
(2) 1/2"

Knockout Ends
(2) 1/2", (2) MKO

APPLICATION AND PERFORMANCE SPECIFICATION INFORMATION IS SUBJECT TO CHANGE WITHOUT NOTIFICATION

CONTRACTOR	
PROJECT	DATE
PREPARED BY	MODEL : CM-GDB-1

CERTIFICATIONS

Listing
UL Listed

Fire Rating
Acceptable for use in 2-hour fire rated walls.

ORDERING INFORMATION

Part Number: CM-GDB-1

Case Dimensions (in.): ???

Case Quantity: 50 PCS

Item Weight (lbs.): ???

Case Weight (lbs.): 35

UPC BARCODES

	GTIN-12	GTIN-14	IMS Code
CM-GDB-1	190010380428	00190010380428	0262-8111



APPLICATION AND PERFORMANCE SPECIFICATION INFORMATION IS SUBJECT TO CHANGE WITHOUT NOTIFICATION