

MODEL :		TYPE
PROJECT :		
PREPARED BY :	DATE :	

SERIES SPECIFICATIONS

HANDY BOX COVER, 1/2" K.O.



LINE DRAWING

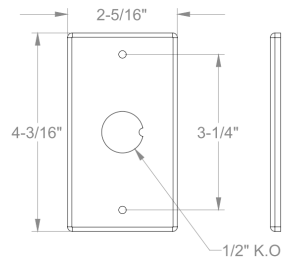

CONSTRUCTION

Material
Sheet Steel

Mfg. Process
Flat

Finish
Galvanized

DIMENSIONS

Width (In.)
2 5/16

Height (In.)
4 3/16

Device Mounting Hole Thread
6-32

No. of Gangs
1/2" KO

Device Mounting Hole Spacing
3 1/4

APPLICATION AND PERFORMANCE SPECIFICATION INFORMATION IS SUBJECT TO CHANGE WITHOUT NOTIFICATION

MODEL :		TYPE
PROJECT :		
PREPARED BY :	DATE :	

ORDERING INFORMATION

Part Number: CM-HBC-BK

Case Weight (lbs.): 2.3

Case Quantity: 25 PCS

APPLICATION AND PERFORMANCE SPECIFICATION INFORMATION IS SUBJECT TO CHANGE WITHOUT NOTIFICATION