

CONTRACTOR	
PROJECT	DATE
PREPARED BY	MODEL : WI LQA1

SERIES SPECIFICATIONS

Centaur's liquid tight connectors are suitable for indoor or outdoor locations to connect flexible metallic liquidtight conduit, and Type B flexible non-metallic conduit, to a box or enclosure. Product features our patented, split gland ring that assures a liquid tight seal. All metallic components are zinc electro plated for corrosion resistance.



LINE DRAWING

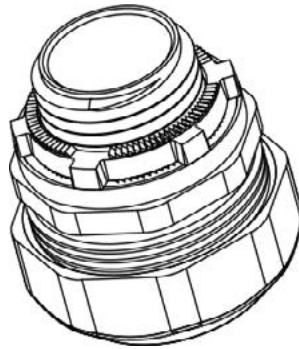

CONSTRUCTION

Body Material
Steel-Zinc Die Cast

Color
Galvanized

Seal Type
Sealing Ring

Seal Material
Polyethylene

CERTIFICATIONS/WARRANTY

Listing
UL Listed

Location Rating:
Suitable for Wet locations

UL Listed liquidtight flexible metal conduit fittings are suitable for use in the following hazardous locations under NEC, Class I, Division 2; Class II, Division 1 and 2; and Class III, Division 1 and 2, and are suitable for grounding in sizes 3/8" through 1-1/4" under NEC.

APPLICATION AND PERFORMANCE SPECIFICATION INFORMATION IS SUBJECT TO CHANGE WITHOUT NOTIFICATION

CONTRACTOR	
PROJECT	DATE
PREPARED BY	MODEL : WI LQA1

ORDERING INFORMATION

Catalog Number	Trade Size.	Std. Pkg.	IMS Code
WI LQA1050	1/2"	25	0258-2916
WI LQA1075	3/4"	15	0258-2929
WI LQA1100	1"	8	0263-6331
WI LQA1125	1 1/4"	5	0263-6334
WI LQA1150	1 1/2"	4	0263-6337
WI LQA1200	2"	1	0263-6340
WI LQA1250	2 1/2"	1	0272-2416
WI LQA9100	3"	1	0272-2419
WI LQA9100	4"	1	0272-2422

APPLICATION AND PERFORMANCE SPECIFICATION INFORMATION IS SUBJECT TO CHANGE WITHOUT NOTIFICATION